

FOR SALE

Prime Commercial Property

1700 Asheville Highway • Hendersonville, NC

Offered at \$895,000

Gary Jones, CCIM, Sid Blythe

Jones Commercial Properties

(828) 243-8490 • garyjones@ccim.net

This property is deed restricted against the use of a financial institution for a period of five years ending July 2018.

**2070 +/- Square Foot Building • 1.22 +/- Acres • Multiple
Ingress / Egress Driveways
Mature Landscaping • 25 Parking Spaces •
Commercial & Industrial Zoned**

- Signal Light Intersection
 - 5 Lane Highway
 - Corner Lot
 - All Utilities
 - High Visibility
 - 22,000 Cars Per Day (Source NC DOT)
- CONCRETE ISLAND CONCRETE ISLAND
CONCRETE ISLAND LANE LANE LANE LANE COVERED DRIVE THRU LANES STORAGE STORAGE VAULT VAULT
OFFICE OFFICE LOBBY ENTRANCE COUNTER DRIVE UP WINDOW BATH BATH OFFICE BREAK MECH. COMPUTER
SUPPORT DOUBLE DOORS DOORS

1.22 +/- Acres zoned for commercial use. Prime site for redevelopment.

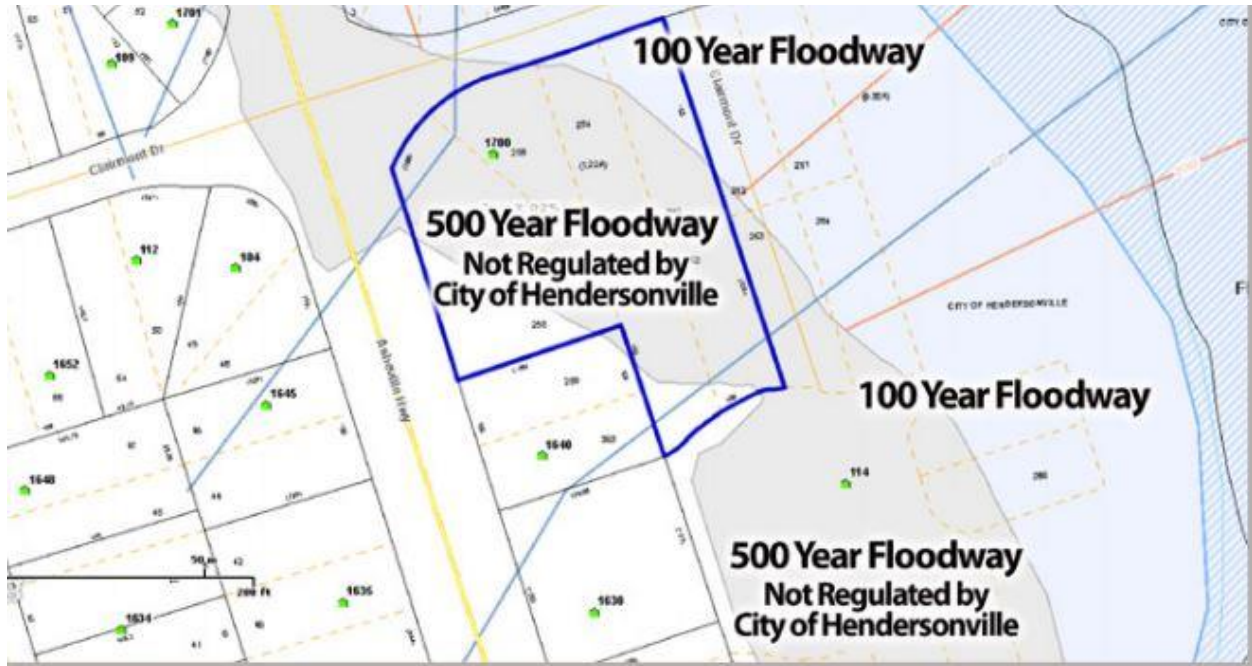

EXCELLENT LOCATION!

Gary Jones, CCIM, Sid Blythe
Jones Commercial Properties

619 Spartanburg Hwy. Hendersonville, NC 28792

www.jonescommercial.com

This is a marketing illustration only and subject to matters of survey, errors, omissions and change without notice. No warranties are expressed or implied. Not to scale. All information subject to buyer verification.

Not to scale

Call JCP Today: (828) 243-8490

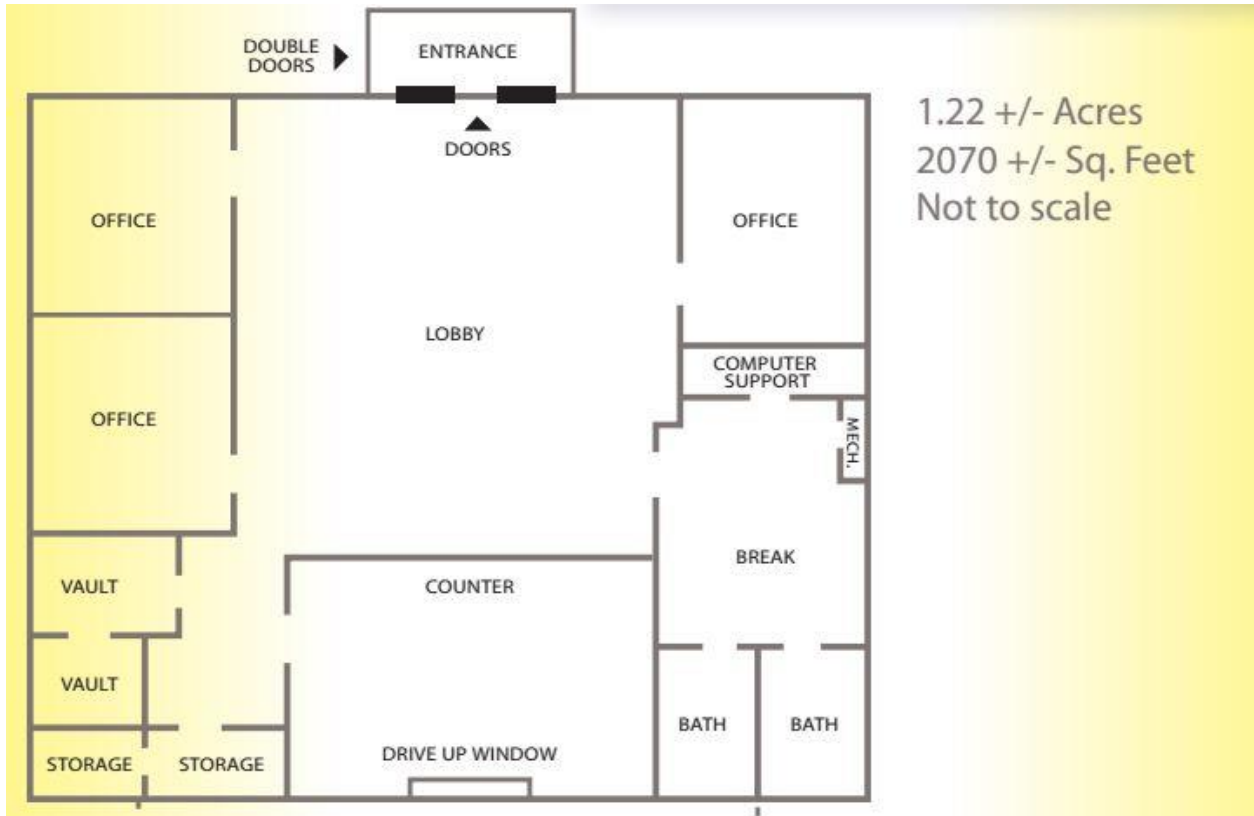

FOR SALE

Prime Commercial Property

